

Protection Against Airborne Hazards

VDEX VACCUM DUST EXTRACTION SYSTEMS

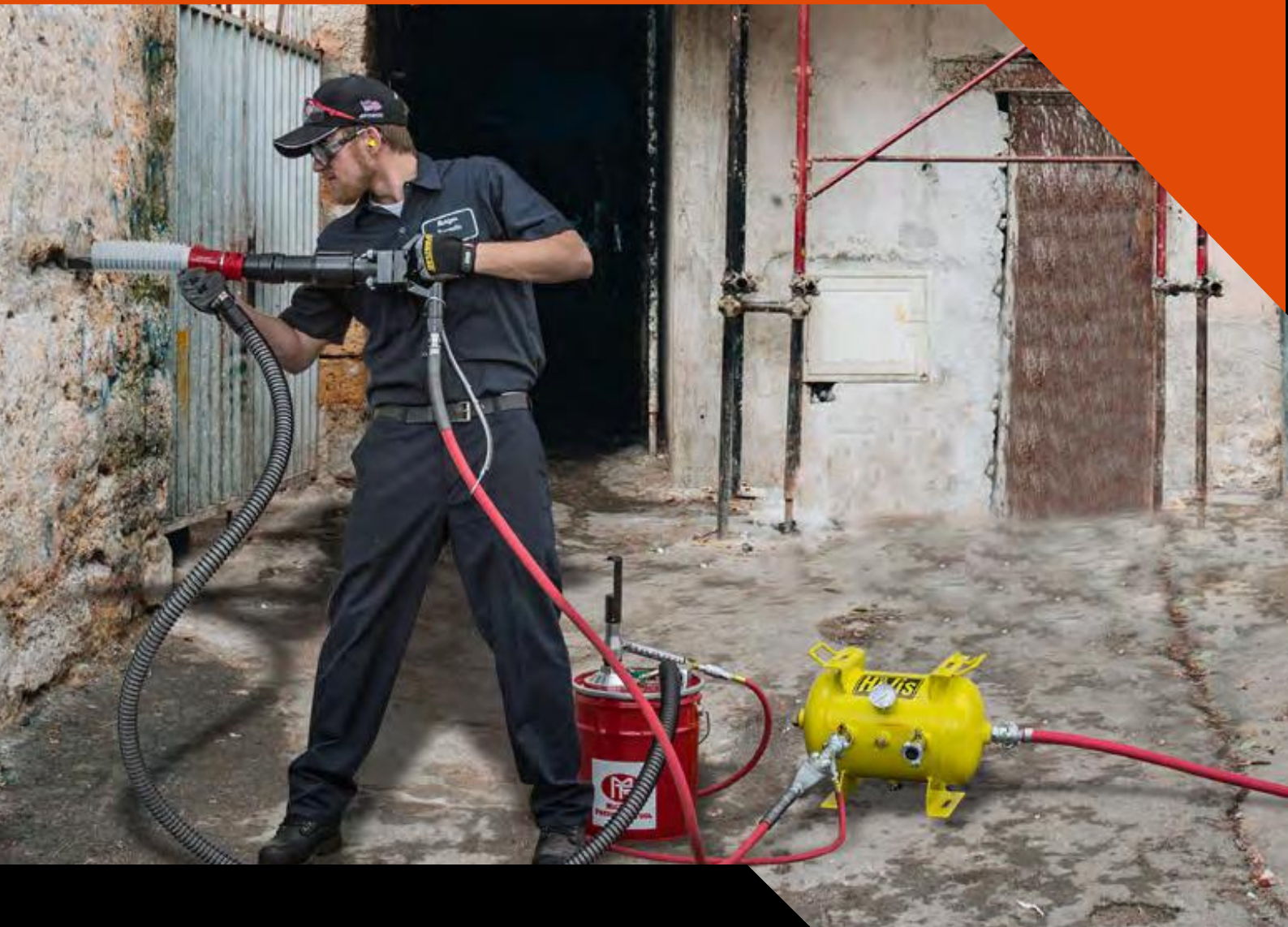

Industries Ideal For:

**RENTAL, DEMOLITION,
CONSTRUCTION, INDUSTRIAL,
FOUNDRY, PETRO CHEMICAL,
SHIPYARDS**



THE ALL-IN-ONE
EQUIPMENT SHOP

AirPlant Services Pty Ltd

BUST THE DUST

VDEX™ is our abbreviation for **V**acuum **D**ust **EX**traction system = **VDEX™**

We were faced with a challenge to design a system that is familiar for the operators of the tools as well as the distributors. We utilized our experience, common sense and listened to the voice of distributors and users of our tools to design, engineer and patent the VDEX systems.

Requirements were:

- Support OSHA table 1 compliance
- Affordable low initial cost
- Lowest operational cost
- Simple and sturdy parts
- Compact and user-friendly installation
- Interchangeability between brands
- Universal parts between models and sizes where possible

With this list of requirements we have created the **VDEX** system.

VDEX attachments are the industry's first uniquely designed attachments for pneumatic tools. VDEX is an engineered solution with the quality and durability that matches that of the industrial "rental" tools they are attached to. The VDEX attachments are designed with the purchaser in mind using common parts such as retainers and springs (which attach the snorkel to the tool), a poly bumper (for durability), and interchangeable parts between tool formats (Chipping Hammers, Rivet Busters, Roto Hammers, Pavement Breakers and Rock Drills) to reduce the number of unique parts needed on a job site or rental outlet. The interchangeability reduces the number of SKUs the rental outlet or job site must maintain. If you need an attachment designed and engineered for a tool not shown in the following pages please do not hesitate to ask...We love a challenge!

Notice: All VDEX attachments are patent pending.





VDEX

Vacuum Dust  Extraction

CH-VDEX Kits	4
CH-VDEX-1291 Kits	5
RB-VDEX Kits	6
RH-VDEX Kits	7
SC-VDEX-1BL Kit	8
SC-VDEX-1BLNS Kit	9
S1-VDEX Kits	10
T3-VDEX Kits	11
S2-VDEX Kits	12
903-VDEX Kits	13
PB-RD-VDEX Kits	14
JAC-3P Vacuum	16
2199-VDEX-WP-ASM Kits	18
HiVis Air Management	19

CH-VDEX SOLID RETAINER SERIES: OVAL AND ROUND COLLAR FOR FOUR-BOLT OR GOOSENECK CHIPPING HAMMERS

CH-VDEX attachments are brand specific. See chart below for the model of your Chipping Hammer when ordering. The CH-VDEX attaches to the Chipping Hammer using the solid metal retainer as the anchoring mechanism. The retainers have specific tapers or straight shank diameter mounts.



NOTE: For job sites requiring water dust suppression use the **VDEX WATER PLUG**, see page 18 for more accessories.

CH-VDEX COMPONENTS

Get OSHA Table 1 Compliant / Universal Kits



CH-VDEX Kit Consists of:

Part No.	Description
1.	2198-VDEX Bellow O.A.L. 8"
2.	2199-VDEX Snorkel
3.	OR-6X38 O-Ring
4.	2105-VDEX Coupler
5.	1194-2 Retainer Springs (2)
6.	See Chart Chipping Hammer Retainer
7.	HS16 1-1/4" Hose Clamp
8.	HS24 1-1/2" Hose Clamp

ROUND COLLAR

W-SERIES THREADED

OVAL COLLAR

MINI

Round Collar Retainer Kits

Retainers Only Part No.	Tool Specific Kits
1190R-CPT-VDEX	CH-VDEX-CPT-RC (MPT, CP, SUL)
1190R-IR-VDEX	CH-VDEX-IR-RC
1190R-1.942-VDEX	CH-VDEX-APT-RC
HHW1-300-VDEX	CH-VDEX-W-SERIES

Oval Collar Retainer Kits

Retainers Only Part No.	Tool Specific Kits
1190-CPT-VDEX	CH-VDEX-CPT (fits MPT, CP, SUL)
1190-IR-VDEX	CH-VDEX-IR (fits IR)
1190-APT-VDEX	CH-VDEX-APT (fits APT)
1190-MINI-VDEX	*CH-VDEX-MINI
HHW1-300-VDEX	*CH-VDEX-W-SERIES

* W-Series and Mini Retainers are not the same price as standard kits

CH-VDEX-1291

QUICK CHANGE RETAINER SERIES: ROUND COLLAR FOR FOUR-BOLT OR GOOSENECK CHIPPING HAMMERS

One size fits most common industry standard 1291 Series Quick Change Retainers. The unique design of the VDEX Clamshell allows the CH-VDEX-1291 series to be installed over the sleeve of the Quick Change Retainer, regardless of the tool manufacturer (brand) or handle configuration.

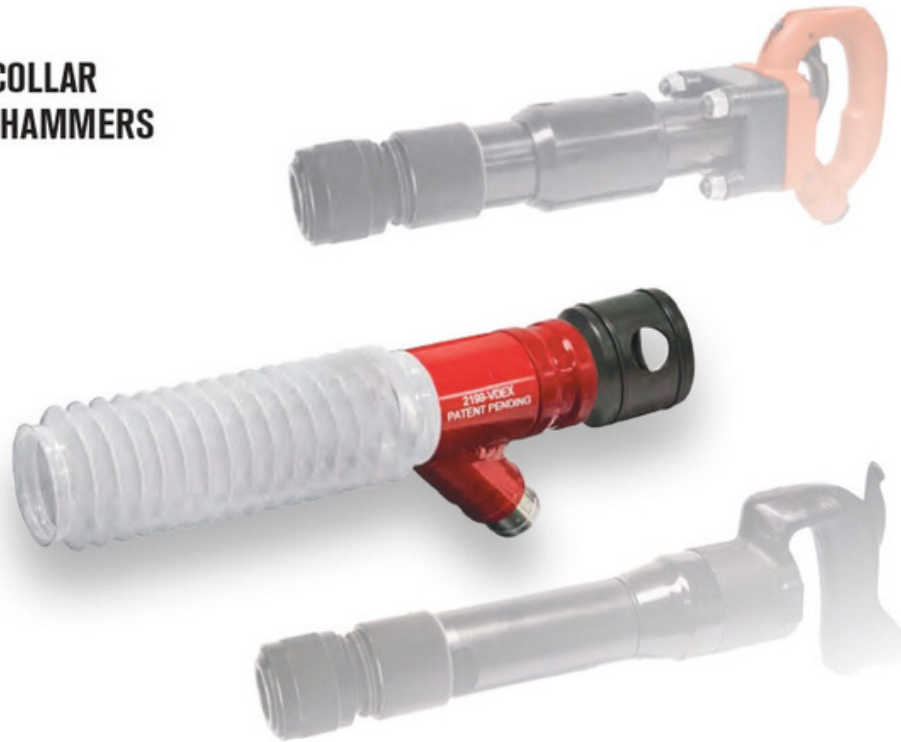

NOTE: For job sites requiring water dust suppression use the **VDEX WATER PLUG**, see page 18 for more accessories.

CH-VDEX-1291 COMPONENTS

Get OSHA Table 1 Compliant / Universal Kits



CH-VDEX-1291 Kit Consists of:

Part No.	Description
1.	2198-VDEX Bellow O.A.L. 8"
2.	2199-VDEX Snorkel
3.	OR-6X38 O-Ring
4.	2105-VDEX Coupler
5.	1194-2 Retainer Springs (2)
6.	VV-0199-1291QC Clamshell Adapter
7.	
8.	HS16 1-1/4" Hose Clamp
9.	HS24 1-1/2" Hose Clamp



Clamshell Adapter and O-Rings

One size fits all Q.C. retainers

VV-0199-1291QC



Quick Change Retainer Kits

Retainer with Clamshell & O-Rings

1291-SUL2-VDEX (MPT, CP, SUL)

1291-IRC2-VDEX (IR)

1291-1.942-VDEX (APT)

RB-VDEX ONE SIZE FITS ALL RIVET BUSTERS

Rivet Buster VDEX attachments are designed to fit every Rivet Buster in the rental and industrial market today. We can accommodate any Rivet Buster, with VDEX attachments.



NOTE: For job sites requiring water dust suppression use the **VDEX WATER PLUG**, see page 18 for more accessories.

RB-VDEX COMPONENTS

Get OSHA Table 1 Compliant / Universal Kits



RB-VDEX Kit Consists of:

Part No.	Description
1.	2198-VDEX Bellow O.A.L. 8"
2.	2199-VDEX Snorkel
3.	OR-6X38 O-Ring
4.	2105-VDEX Coupler
5.	1194-2 Retainer Springs (2)
6.	2104P-RED Polymer Bumper
7.	2103-VDEX Extended Lower Sleeve
8.	2194 Retainer Spring
9.	HS16 1-1/4" Hose Clamp
10.	HS24 1-1/2" Hose Clamp



Split Sleeve Kit

Split Extended Lower Sleeve
RB-VDEX-SPL

Optional Split Sleeve



2103S-VDEX Split Extended Lower Sleeve
Required when using Bushing Tools and Wide Buster Chisels

RH-VDEX

ROTO HAMMER RETAINER KITS CLAMSHELL DESIGN FITS OVER TOOL

RH-VDEX attachments are designed to fit a variety of tool brands. See chart below for the model of your Roto Hammer when ordering.

The RH-VDEX attaches to the Roto Hammer using the VDEX Clamshell design. Simply install the clamshell over the nose of the Roto Hammer and install O-Rings. Then attach the coupler with retainer springs to the snorkel and bellow assembly.



NOTE: For job sites requiring water dust suppression use the **VDEX WATER PLUG**, see page 18 for more accessories.

RH-VDEX COMPONENTS

Get OSHA Table 1 Compliant / Universal Kits



RH-VDEX Kit Consists of:

Part No.	Description
1. 2198-VDEX	Bellow O.A.L. 8"
2. 2199-VDEX	Snorkel
3. OR-6X38	O-Ring
4. 2105-VDEX	Coupler
5. 1194-2	Retainer Springs (2)
6. See Chart	Roto Hammer Clamshell
7. OR-6230-2	O-Rings (3)
8. HS16	1-1/4" Hose Clamp
9. HS24	1-1/2" Hose Clamp

RH-VDEX-9B
(MP-9B, CP-9B)



RH-VDEX-MRD9
(SUL-MRD9)



RH-VDEX-THD1100
(TOKU THD-1100N)



RH-VDEX

Clamshell Adapters Only

VV-0199-9B
VV-0199-MRD9
VV-0199-THD1100N

Roto Hammer Kits

RH-VDEX-9B (MP-9B, CP-9B)
RH-VDEX-MRD9 (SUL-MRD9)
RH-VDEX-THD1100 (TOKU THD-1100N)

SC-VDEX-1BL CHISEL SCALER STEEL BODY INDUSTRIAL GRADE ATTACHMENT

SC-VDEX-1BL is designed to slip over the nose of the 1BL scaler and attach like a normal needle tube, using the chisel latch as the lock support.



NOTE: Must use longer chisels when using the SC-1BL-VDEX.
 NOTE: Chisels should be installed prior to installing the SC-1BL-VDEX.
 NOTE: SC-VDEX-1BL may not fit all brands or manufacturers of needle scalers.
 NOTE: **VDEX WATER PLUG** will not fit for this model.

SC-VDEX-1BL COMPONENTS

Get OSHA Table 1 Compliant / Universal Kits

1.



2.



3.



4.



SC-VDEX-1BL Kit Consists of:

Part No.	Description
1. 2198-VDEX	Bellow O.A.L. 8"
2. 1BL-STL-VDEX-RED	Snorkel
3. 1371	Spring
4. HS16	1-1/4" Hose Clamp

NOTE: Part No. 2198-VDEX Bellow may be cut to accommodate chisel length.

SC-VDEX-1BLNS NEEDLE SCALER ALUMINUM BODY INDUSTRIAL GRADE ATTACHMENT

SC-VDEX-1BLNS is designed to fit over the needle tube on the 1BL Style Needle Scaler. The aluminum snorkel slides over the nose of the Needle Scaler and an o-ring on the inside of the snorkel keeps the attachment from sliding off the needle tube.



NOTE: SC-VDEX-1BLNS may not fit all brands or manufacturers of needle scalers.
NOTE: **VDEX WATER PLUG** will not fit for this model.

SC-VDEX-1BLNS COMPONENTS

Get OSHA Table 1 Compliant / Universal Kits

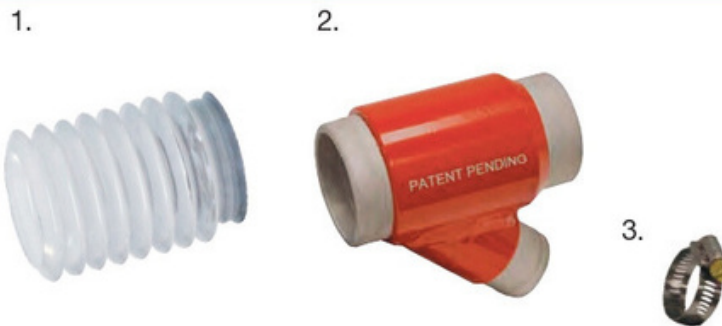

SC-VDEX-1BLNS Kit Consists of:

Part No.	Description
1. 2198-VDEX-HLF	Bellow O.A.L. 4"
2. 1BLNS-AL-VDEX-RED	Snorkel
3. HS16	1-1/4" Hose Clamp

S1-VDEX INDUSTRIAL GRADE ATTACHMENT

The S1-VDEX is designed to easily attach to the S1 single piston scabblers using the factory live handle assembly. The bristled skirt surrounds the piston to contain dust and debris to allow the vacuum to draw the dust away from the work area.



NOTE: For job sites requiring water dust suppression use the **VDEX WATER PLUG**, see page 18 for more accessories.

S1-VDEX COMPONENTS

Get OSHA Table 1 Compliant / Universal Kits



2.



3.



4.



S1-VDEX Kit Consists of:

Part No.	Description
1. S1-VDEX-BLK	Housing
2. OR-6227-12	O-Ring
3. N3-500NPT	1/2" NPT Jamnut
4. TWB-W70	7/8" Washer

T3-VDEX INDUSTRIAL GRADE ATTACHMENT

T3-VDEX is designed to easily attach to the T3 triple piston scabblers using the factory live handle assembly. The live handle can be installed in either side of the T3 scabblers (shown in perpendicular configuration.) The live handle and dead handle retain the aluminum skirt on to the body of the T3 scabblers. The bristled skirt surrounds the pistons to contain dust and debris to allow the vacuum to draw the dust away from the work area.



NOTE: For job sites requiring water dust suppression use the *VDEX WATER PLUG*, see page 18 for more accessories.

T3-VDEX COMPONENTS

Get OSHA Table 1 Compliant / Universal Kits



T3-VDEX Kit Consists of:

Part No.	Description
1. T3-VDEX-BLK	Housing
2. OR-6227-12	O-Ring (2)
3. N3-500NPT	1/2" NPT Jamnut
4. TWB-W70	7/8" Washer

S2-VDEX INDUSTRIAL GRADE ATTACHMENT

The S2-VDEX is designed to easily attach to the S2 single piston scabblers using the factory live handle and pipe assembly. The bristled skirt surrounds the piston to contain dust and debris to allow the vacuum to draw the dust away from the work area.

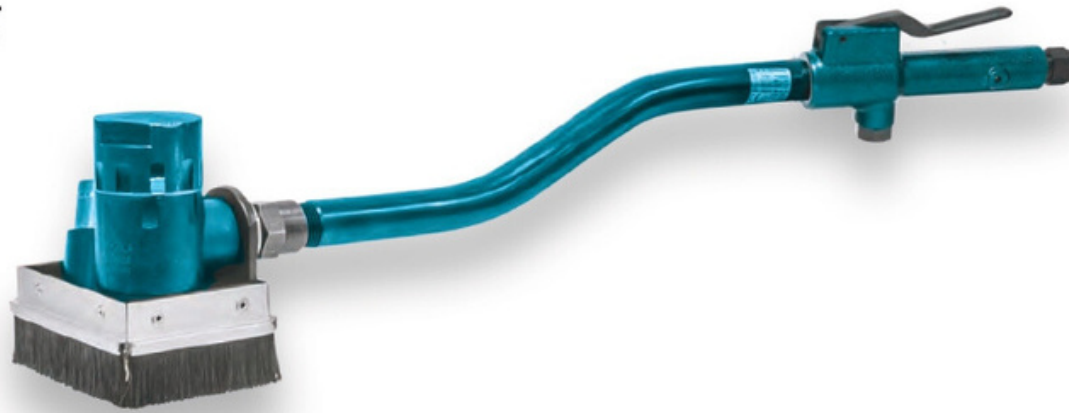

NOTE: For job sites requiring water dust suppression use the *VDEX WATER PLUG*, see page 18 for more accessories.

S2-VDEX COMPONENTS

Get OSHA Table 1 Compliant / Universal Kits

1.



2.



3.



4.



S2-VDEX Kit Consists of:

Part No.	Description
1. S2-VDEX-BLK	Housing
2. OR-6227-12	O-Ring
3. N3-500NPT	1/2" NPT Jamnut
4. TWB-W70	7/8" Washer

903-VDEX INDUSTRIAL GRADE ATTACHMENT

903-VDEX is designed to easily attach to the 903 triple piston scabblers using the factory live handle and pipe assemblies. The bristled skirt surrounds the pistons to contain dust and debris to allow the vacuum to draw the dust away from the work area.



NOTE: For job sites requiring water dust suppression use the *VDEX WATER PLUG*, see page 18 for more accessories.

903-VDEX COMPONENTS

Get OSHA Table 1 Compliant / Universal Kits



903-VDEX Kit Consists of:

Part No.	Description
1. 903-VDEX-BLK	Housing
2. OR-6227-12	O-Ring (2)

PB-RD-VDEX PAVEMENT BREAKER AND ROCK DRILL ATTACHMENT

- PB-RD-VDEX fits all pneumatic, electric and hand held hydraulic Pavement Breakers, regardless of class and shank size.
- The PB-RD-VDEX also fits all Rock Drills.
- Our patented Friction Mag design attaches to the chisel rather than the tool.
- The patented Friction Mag device allows the PB-RD-VDEX to be used on Rock Drill applications.

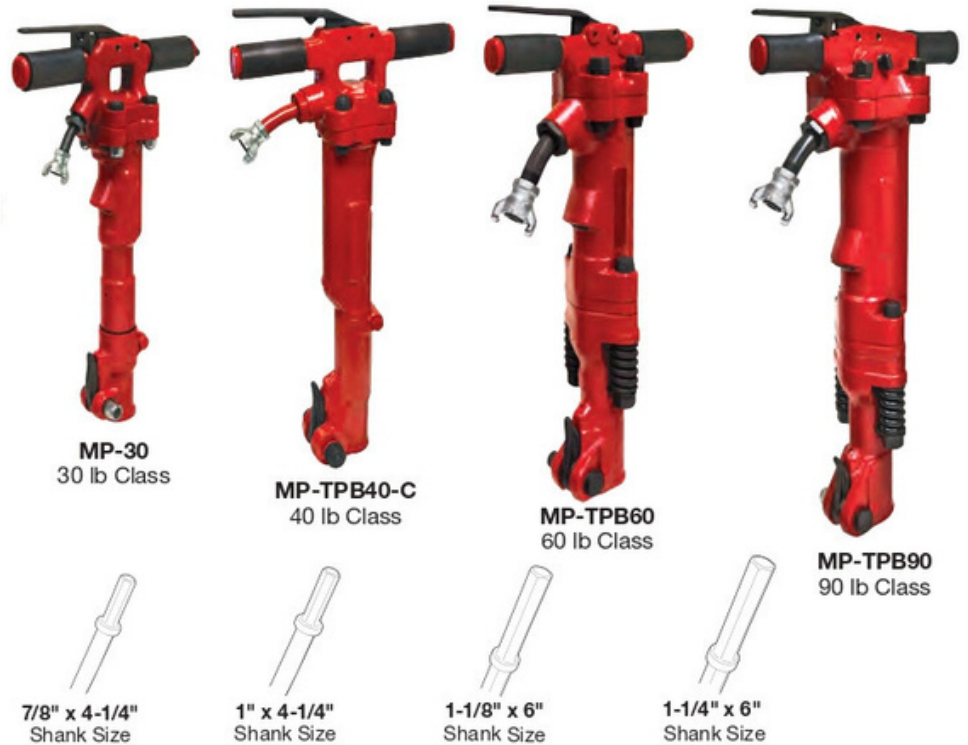

NOTE: For job sites requiring water dust suppression use the **VDEX WATER PLUG**, see page 18 for more accessories.

PB-RD-VDEX COMPONENTS

Get OSHA Table 1 Compliant / Universal Kits

YOUR UNIVERSAL SOLUTION!

- FITS PNEUMATIC, ELECTRIC AND HAND HELD PAVEMENT BREAKERS.
- FITS ALL ROCK DRILLS, TOO.
- ONE SIZE FITS ALL!

PB-RD-VDEX Kit Consists of:

Part No.	Description
1. 2199-PB-RD-VDEX	Snorkel Attachment
2. 2198-VDEX	Bellow O.A.L. 8"
3. HS16	1-1/4" Hose Clamp
4. HS24	1-1/2" Hose Clamp

Accessories (Not Included in Kit)

5. VV-0021	Bellow Extension
6. VDEX-NZL-4IN	Bristle Foot Extension



PB-RD-VDEX PAVEMENT BREAKER AND ROCK DRILL ATTACHMENT

- PB-RD-VDEX fits all pneumatic, electric and hand held hydraulic Rock Drills.
- Our patented Friction Mag design attaches to the chisel rather than the tool.
- The Friction Mag device rotates when used with Rock Drills.
- The Friction Mag device allows the PB-RD-VDEX to be easily installed over the shank and collar end of all Rock Drill Steel.
- When using Rock Drill Steel and bits over 1-7/8" diameter it is recommended that you use the VDEX-NZL-4IN bristle foot.



MP-RD30-78314



MP-RD62-78314



MP-ERD60



7/8" x 3-1/4"
Shank Size



7/8" x 4-1/4"
Shank Size



1" x 4-1/4"
Shank Size

NOTE: For job sites requiring water dust suppression use the **VDEX WATER PLUG**, see page 18 for more accessories.

PB-RD-VDEX COMPONENTS

Get OSHA Table 1 Compliant / Universal Kits

YOUR UNIVERSAL SOLUTION!

- FITS PNEUMATIC, ELECTRIC AND HAND HELD ROCK DRILLS.
- FITS ALL PAVEMENT BREAKERS, TOO.
- ONE SIZE FITS ALL!

PB-RD-VDEX Kit Consists of:

Part No.	Description
1. 2199-PB-RD-VDEX	Snorkel Attachment
2. 2198-VDEX	Bellow O.A.L. 8"
3. HS16	1-1/4" Hose Clamp
4. HS24	1-1/2" Hose Clamp

Accessories (Not Included in Kit)

5. VV-0021	Bellow Extension
6. VDEX-NZL-4IN	Bristle Foot Extension



JAC-3P VACUUM DUST EXTRACTION VACUUM SYSTEM FOR ALL VDEX ATTACHMENTS

The VDEX system was designed for OSHA table 1 compliance, when used according to manufacturing instructions. The JAC-3P utilizes a water-based filtration system making it compact, affordable and user-friendly.



VDEX-WHIP
3-Way Whip Hose



JAC-3P
Venturi Vacuum
Complete with Pail & 1-1/4" x 10 ft
Anti-Static Vacuum Hose

OPERATION AND USE

The JAC-3P vacuum is an air operated venturi vacuum designed to be used in conjunction with the VDEX attachments for dust collection. The vacuum is supplied with a "T" connection called the VDEX-WHIP. Connect the VDEX-WHIP to the main air supply. The Quick Coupler end of the hose will connect to the vacuum. That will leave two open ports on the "T" fitting; one for the 3/4" supply line from the air source and the other port will connect the whip hose.

Once the air is connected, follow the remaining instructions provided in the operating manual. The water level, air pressure and volume is important to the performance of the vacuum. If these variables are not maintained the performance will vary.

The JAC-3P uses water as a filter for the dust. It is not to pick up larger particles. It is to remove respirable dust from the work surface, away from the operator and direct it into the water. This unit operates at 90 psi on a 3/8" airline. Creating 25 cfm to 30 cfm of air flow through the vacuum line.

The water should be checked and changed out periodically. This will depend on the level of dust created. Breaking and busting produces significantly less dust than a Rock Drill or Roto Hammer. If the performance of the vacuum diminishes, check the water level and solids collected in the bottom of the pail. Empty accordingly to your job site regulations.

JAC-3P VACUUM COMPONENTS

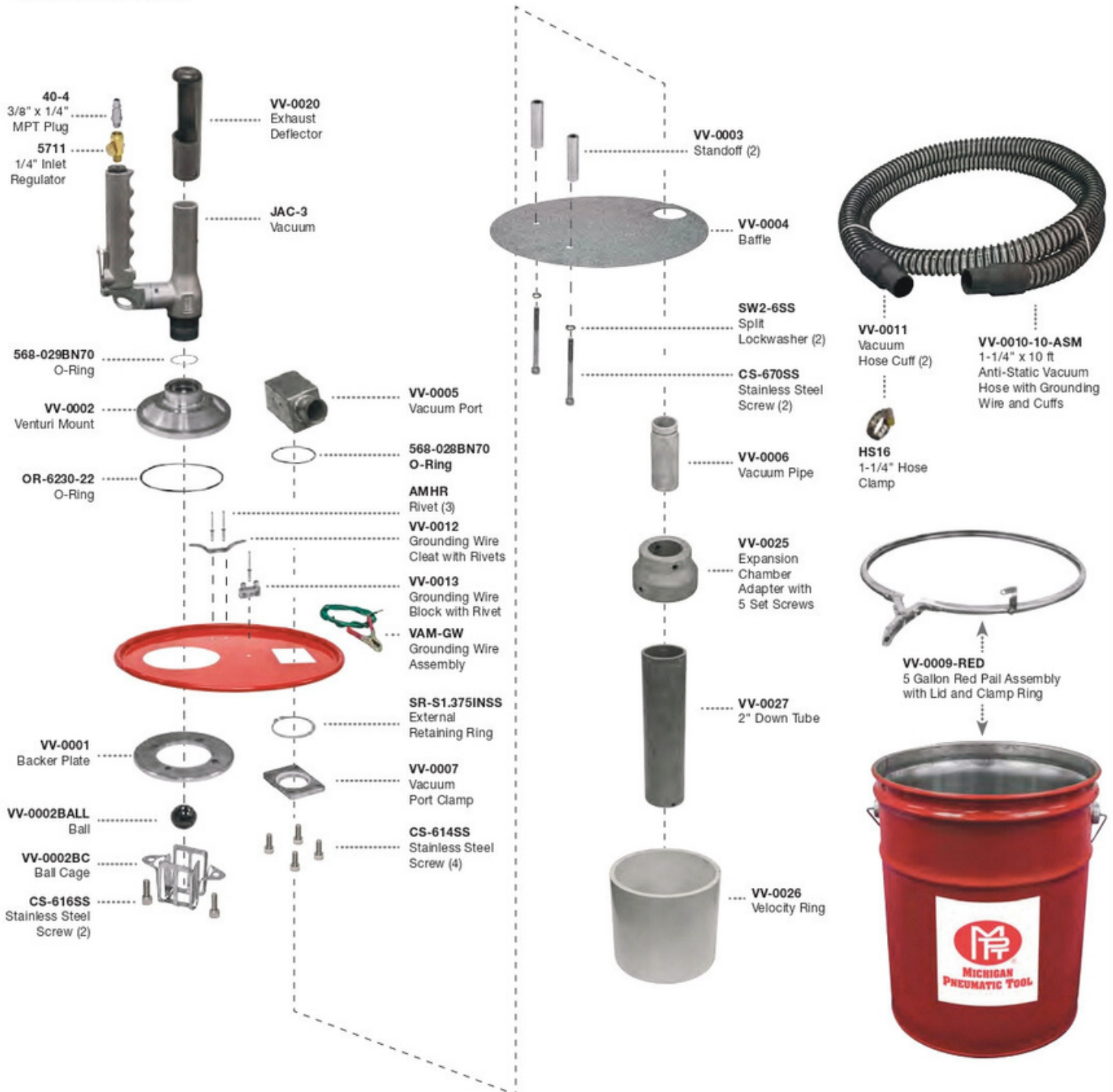

2199-VDEX-WP-ASM WATER PLUG FOR USE WITH VDEX ATTACHMENTS

The VDEX Water Plug attachment was designed for applications that require water to suppress dust. It can easily be used with your existing 2199-VDEX Snorkel or PB-RD-VDEX Pavement Breaker/Rock Drill attachment.



2199-VDEX shown with Water Plug Attachment. For use with Chipping Hammers, Roto Hammers, and Rivet Busters.



PB-RD-VDEX shown with Water Plug Attachment. For use with Pavement Breakers and Rock Drills.

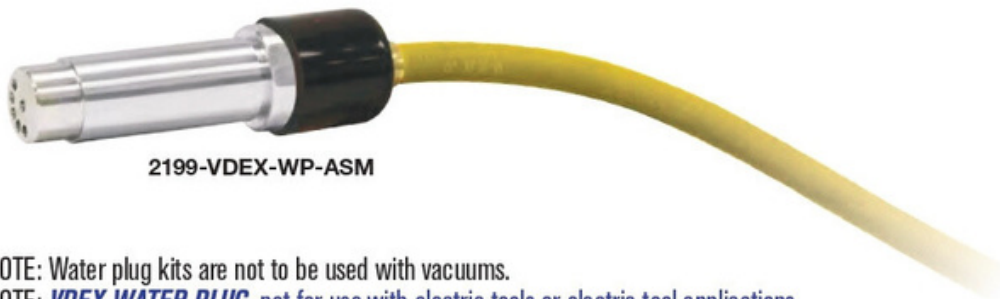

2199-VDEX-WP-ASM

NOTE: Water plug kits are not to be used with vacuums.
NOTE: **VDEX WATER PLUG**, not for use with electric tools or electric tool applications.

2199-VDEX-WP-ASM COMPONENTS

Get OSHA Table 1 Compliant / Universal Kits



2199-VDEX-WP-ASM Kit Consists of:

Part No.	Description
1. 568-020BN70	O-Ring
2. 2199-VDEX-WPADP	Water Plug Adapter
3. 2199-VDEX-WPCAP	Water Plug Cap
4. CT-134-50	Zip Tie
5. WH-2	10 ft Hose Assembly
6. T400FM	1/4" Mini Ball Valve
7. PF20984	1-1/2" Bushing 1/2" M x 1/4"
8. 10003W	Swivel Hose w/R05103W



MOISTURE SEPARATOR WITH AUTOMATIC DRAIN WALL MOUNT OR HAND CARRY

The portable design delivers clean air in the most confined and remote places. The Moisture Separator removes 100% of visible moisture from air lines and is constructed of high strength steel. Simple to set up and no maintenance required. Features an auto drain valve.

Model	Diameter	Height	Weight	Working Pressure
HV-S7F	6"	9-1/2"	11 lbs	100 psi
HV-S7F-CARRIER	9-1/2"	15-1/2"	15.5 lbs	100 psi



HV-S7F
Air Moisture Separator
(Wall Mount)



HV-S7F-CARRIER
HiVis S7F Filter Carrier



HV-TWIN-PAK

Our HiVis Twin-PAK allows two operators to run tools simultaneously from one air supply. Compact, portable and stackable. Designed to deliver dry, clean, lubricated air. Visible moisture is 100% removed and automatically purged by the integrated HV-S7F water filter which is virtually maintenance free. The integrated 1LF filter/lubricator combo filters air down to 40 microns, and has a 3.7 oz oiler. As a bonus feature, a safety excess flow check valve will shut air off to both tools in the event of an air hose being severed or hose connection coming lose.

Height	Length	Depth	Weight
15"	29"	10"	32 lbs



Silica Dust Suppression

HV-TWIN-PAK-H2OX2

AIR DISTRIBUTION MANIFOLD W/ WATER ATTACHMENT

The Twin Pak uses the HV-S7F Filter to separate the water then filters and lubricates the air which then passes through the safety excess flow check valve. HV-Twin-Pak-H2OX2 is the only product to provide filtered air, oil, and dust suppression water to the tool safely. Simply connect your air tool as normal to your whip hose, strap the water line to the side of the whip hose and tool, then point the nozzle at the work surface and begin to work.

Height	Length	Depth	Weight	Avg. Air Cons.
13.25"	18.5"	10"	41.5 lbs	160-180 cfm

HYDRAULIC WHIP HOSE ASSEMBLIES



3HW-HYD



3HW-HYD-F

Model	Assembly Components			
	Fitting to Tool	Hose	Lubricator	Filter
2HW-HYD	3/8" MPT			-
3HW-HYD	1/2" MPT	1/2" ID x 6 ft	0-R w/CP Fitting	-
3HW-HYD-F	1/2" MPT			9074M



CONTACT US

We Look Forward To Partnering With You.
Any Questions? Reach Out For More
Information.

e: sales@apgaustralia.com.au

p: 1300 763 100

www.apgaustralia.com



THE ALL-IN-ONE
EQUIPMENT SHOP